

Hillmar

Hillmar Industries Ltd.

7371 Vantage Way
Delta, BC V4G 1C9
P:604 946-7115 F:604 946-0329
info@hillmar.com www.hillmar.com

**CABLE REEL DMF
DMF-GB25-20KV
DRIVE MOUNT FRAME
SLS & MKTG
ENGLISH**

Sheet Number:
Job Number:
Form Number:
629-830-89170PT
Document Package No.: Rev.:

Company / Project Reference: Date.: Page.: 1 OF 1

Inventor Drawing

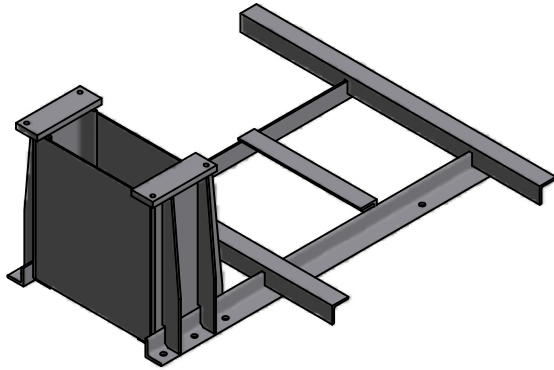

FEATURE	CODE
Drive mounting frame	DMF
Gearbox size	GB25
Slipping Enclosure	20KV

Example for ordering **DMF-GB25-20KV**

TECHNICAL DATA	
Material Structural Steel	44W
Mounting holes (frame)	8xØ22
Mounting bolts (frame)	8xM20
Weight (kg)	158

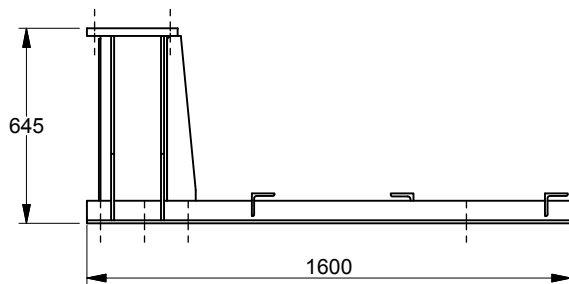
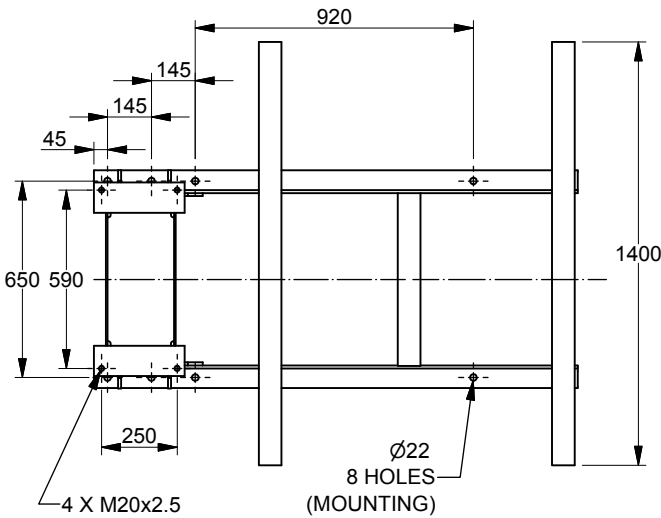

NOTES
All figures are nominal figures only
All dimensions are in millimeters

Document Template #710-101-62058

** ALL TECHNICAL DATA IS SUBJECT TO CHANGE WITHOUT NOTICE **
Hillmar works have a fully registered ISO 9001-2008 quality assurance programme (QCB #01-1525)

C:\Vault_Workspace\HILLMAR\PRODUCTION\06 CABLE REEL\CABLE REEL\CABLE REEL PART\0700-6\07006008 CRPRTS\02 SPC-SHT-CRPRTS\11 DMF\89170 DMF-GB25-20KV.idw